



## Cura1 Wireless bed pad kit home use

### A-CBP-KIT-HOME



The Cura1 Wireless bed pad kit home use is an industry standard falls prevention system, that allows for a career in the home to have more flexibility and be alerted if an unassisted bed exit is detected.

The Cura1 monitor can detect up to 7 different transmitters which allows for a chair pad to be used with the same monitor.

Kit contains:

1 x Wireless Bed Pad

1 x Wireless Bed  
transmitter

1 x Wireless Pad Monitor

# Product Specifications

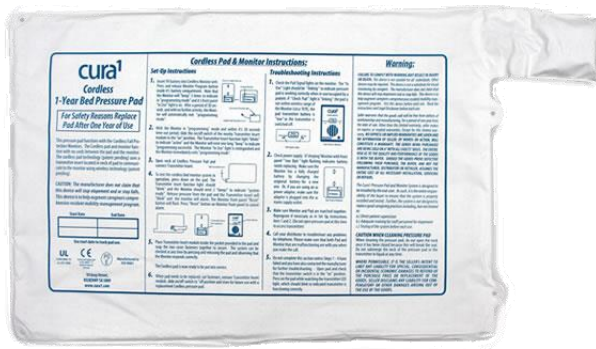

## A-CBP-01 WIRELESS BED PAD

### Features:

Simple operation

Easy to clean

For use with cura1 2719 Cordless Pad Transmitter

made from non-allergenic soft PVC

Vent holes in the neck reduce the risk of moisture ingress

Dimensions 760 x 510mm

1 Year life expectancy

Recommended weight range for reliable operation: 30kg to 200kg



## A-CL433-TX WIRELESS PAD TRANSMITTER

### Features:

Simple operation

For use with cura1 Cordless Pads and Monitors

15- 20m Range

Fits inside cordless pads

433MHz operating frequency

70mm x 55mm x 15mm

1-year battery life

status/in-use LED indication

on/off switch



### **A-CBM-02 WIRELESS PAD MONITOR**

Features:

Monitor up to 7 wireless devices simultaneously.

Works with a hardwired pad/mat.

Comes with durable silicon cover

Amber LED visual alarm indicator.

Caregiver secure reset option.

Battery operated or optional external plug pack.

Up to 6 months battery life (nominal).

Easy to access battery compartment.

3 selectable alarm tones.

adjustable alarm volume.

“Pause” feature allows caregiver to attend to the patient without setting the alarm off.

DC operation using either 3 x AA batteries or 6V plug pack

Dimensions 120 x 77 x 40mm

Weight 150g without batteries

Up to 20m range when used with cordless bed pads and chair pads

Fully user programmable

Operating temperature 5 - 40 degrees Celsius, relative humidity < 85%

3 selectable alarm tones

Operating frequency 433Mhz fully supervised

Volt free normally open relay contact alarm output

RJ10 type socket for optional wired bed/chair pad or floor mat connection

Low battery detection

Missing AC/DC power supply detection and indication